

CERTIFIED LAND CORNER RECORDATION

DESCRIPTION OF CORNER EVIDENCE FOUND, AND ORIGINAL RECORD (if known)

LOCATION

Found 4" x 7" x 12" granite boulder, floating.

G.L.O. record: Granite boulder, 15 x 8 x 6, John B. Thomas, 1871.

Obliterated corner, see "Report of Survey" for details.

1/4
S.33 S.34
T.16N., R.65W.
6th P.M.

DESCRIPTION OF MONUMENT AND ACCESSORIES ESTABLISHED TO PERPETUATE THE ORIGINAL LOCATION OF THIS CORNER:

At the corner: Set a 1 1/2" dia. x 30" long iron pipe with brass cap.

Accessories: Set a 4" x 4" redwood witness post, 3' east of corner monument.

Left stone as memorial.

SKETCH, WITH COURSE AND DISTANCE TO ADJACENT CORNER IF DETERMINED IN THIS SURVEY. (May Sketch or Paste Reproduction on Reverse Side.)

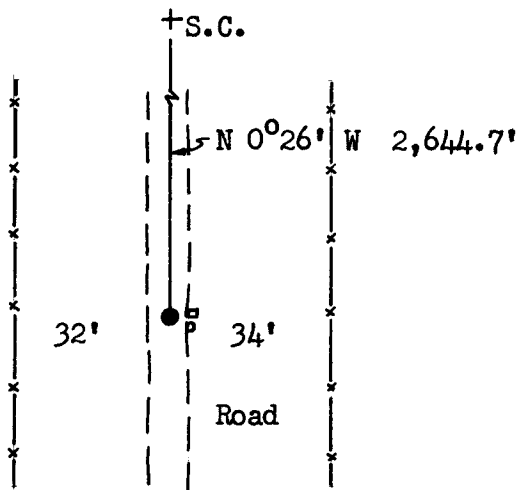

1"=40'

Brass cap set flush with road surface.

Brass cap stamped:

T.16N. R.65W.

1/4

S.33 S.34

LS 519 1972

I, R.L. Hudson certify that I have carefully performed or reviewed the work done on the diagrammed corner as reported on this recordation form and approve the same.

R.L. Hudson
Signature of Surveyor

Wyoming L.S. No. 519
Registration No.

STATE OF WYOMING,
Office of Clerk and Recorder,
County of Laramie

This "corner record" was filed for record on the 9th day of August, 1972, was noted on the cross-index plat and is assigned page No. 16-65, in book No. ONE

Johy B. Hillman
County Official

Cross Index No. _____	T. _____	R. _____	Mer. _____
_____	T. _____	R. _____	Mer. _____
_____	T. _____	R. _____	Mer. _____
_____	T. _____	R. _____	Mer. _____
_____	T. _____	R. _____	Mer. _____
_____	T. _____	R. _____	Mer. _____
_____	T. _____	R. _____	Mer. _____
_____	T. _____	R. _____	Mer. _____

The State of Wyoming
County of Laramie

This instrument was filed for record
at 8:59 o'clock A. M. on the
27th day of August,
A. D. 19 22 and duly recorded in
Book _____ on page _____

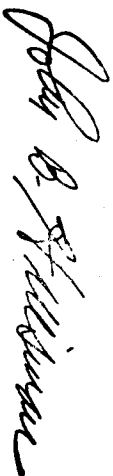

County Clerk & Ex-Officio Register of Deeds
By _____, Deputy